

**P1D Ultra Clean without sensor function**

This version is a permanently sealed P1D Ultra Clean with no facility for installing sensors. The cylinder has a very clean design and is intended for applications where no sensors are used.

The P1D without the sensor function can of course be combined with other equipment and functions.



1	2	3	4	5	6	7	8	9	10	11	12	13	14	15
<b>P</b>	<b>1</b>	<b>D</b>	<b>-</b>	<b>C</b>	<b>0</b>	<b>4</b>	<b>0</b>	<b>H</b>	<b>S</b>	<b>N</b>	<b>0</b>	<b>2</b>	<b>5</b>	<b>0</b>

<b>Cylinder version</b>	<b>P1D Ultra Clean without sensor function is defined by the letter C in position 5, N in position 11 and the 15-digit order code.</b>
<b>C</b> Ultra Clean	

**Without sensor function - HDPE scraper, stainless steel end covers screws**

Cyl. bore mm	Stroke mm	Order code	Cyl. bore mm	Stroke mm	Order code	Cyl. bore mm	Stroke mm	Order code
<b>32</b> Conn. G1/8	25	<b>P1D-C032HSN0025</b>	<b>63</b> Conn. G3/8	25	<b>P1D-C063HSN0025</b>	<b>125</b> Conn. G1/2	25	<b>P1D-C125HSN0025</b>
	40	<b>P1D-C032HSN0040</b>		40	<b>P1D-C063HSN0040</b>		40	<b>P1D-C125HSN0040</b>
	50	<b>P1D-C032HSN0050</b>		50	<b>P1D-C063HSN0050</b>		50	<b>P1D-C125HSN0050</b>
	80	<b>P1D-C032HSN0080</b>		80	<b>P1D-C063HSN0080</b>		80	<b>P1D-C125HSN0080</b>
	100	<b>P1D-C032HSN0100</b>		100	<b>P1D-C063HSN0100</b>		100	<b>P1D-C125HSN0100</b>
	125	<b>P1D-C032HSN0125</b>		125	<b>P1D-C063HSN0125</b>		125	<b>P1D-C125HSN0125</b>
	160	<b>P1D-C032HSN0160</b>		160	<b>P1D-C063HSN0160</b>		160	<b>P1D-C125HSN0160</b>
	200	<b>P1D-C032HSN0200</b>		200	<b>P1D-C063HSN0200</b>		200	<b>P1D-C125HSN0200</b>
250	<b>P1D-C032HSN0250</b>	250	<b>P1D-C063HSN0250</b>	250	<b>P1D-C125HSN0250</b>			
320	<b>P1D-C032HSN0320</b>	320	<b>P1D-C063HSN0320</b>	320	<b>P1D-C125HSN0320</b>			
400	<b>P1D-C032HSN0400</b>	400	<b>P1D-C063HSN0400</b>	400	<b>P1D-C125HSN0400</b>			
500	<b>P1D-C032HSN0500</b>	500	<b>P1D-C063HSN0500</b>	500	<b>P1D-C125HSN0500</b>			
<b>40</b> Conn. G1/4	25	<b>P1D-C040HSN0025</b>	<b>80</b> Conn. G3/8	25	<b>P1D-C080HSN0025</b>	The cylinders are supplied complete with one stainless steel piston rod nut as standard.		
	40	<b>P1D-C040HSN0040</b>		40	<b>P1D-C080HSN0040</b>			
	50	<b>P1D-C040HSN0050</b>		50	<b>P1D-C080HSN0050</b>			
	80	<b>P1D-C040HSN0080</b>		80	<b>P1D-C080HSN0080</b>			
	100	<b>P1D-C040HSN0100</b>		100	<b>P1D-C080HSN0100</b>			
	125	<b>P1D-C040HSN0125</b>		125	<b>P1D-C080HSN0125</b>			
	160	<b>P1D-C040HSN0160</b>		160	<b>P1D-C080HSN0160</b>			
	200	<b>P1D-C040HSN0200</b>		200	<b>P1D-C080HSN0200</b>			
250	<b>P1D-C040HSN0250</b>	250	<b>P1D-C080HSN0250</b>					
320	<b>P1D-C040HSN0320</b>	320	<b>P1D-C080HSN0320</b>					
400	<b>P1D-C040HSN0400</b>	400	<b>P1D-C080HSN0400</b>					
500	<b>P1D-C040HSN0500</b>	500	<b>P1D-C080HSN0500</b>					
<b>50</b> Conn. G1/4	25	<b>P1D-C050HSN0025</b>	<b>100</b> Conn. G1/2	25	<b>P1D-C100HSN0025</b>			
	40	<b>P1D-C050HSN0040</b>		40	<b>P1D-C100HSN0040</b>			
	50	<b>P1D-C050HSN0050</b>		50	<b>P1D-C100HSN0050</b>			
	80	<b>P1D-C050HSN0080</b>		80	<b>P1D-C100HSN0080</b>			
	100	<b>P1D-C050HSN0100</b>		100	<b>P1D-C100HSN0100</b>			
	125	<b>P1D-C050HSN0125</b>		125	<b>P1D-C100HSN0125</b>			
	160	<b>P1D-C050HSN0160</b>		160	<b>P1D-C100HSN0160</b>			
	200	<b>P1D-C050HSN0200</b>		200	<b>P1D-C100HSN0200</b>			
	250	<b>P1D-C050HSN0250</b>		250	<b>P1D-C100HSN0250</b>			
	320	<b>P1D-C050HSN0320</b>		320	<b>P1D-C100HSN0320</b>			
400	<b>P1D-C050HSN0400</b>	400	<b>P1D-C100HSN0400</b>					
500	<b>P1D-C050HSN0500</b>	500	<b>P1D-C100HSN0500</b>					



**P1D-C (Ultra Clean) Series**

Without sensor

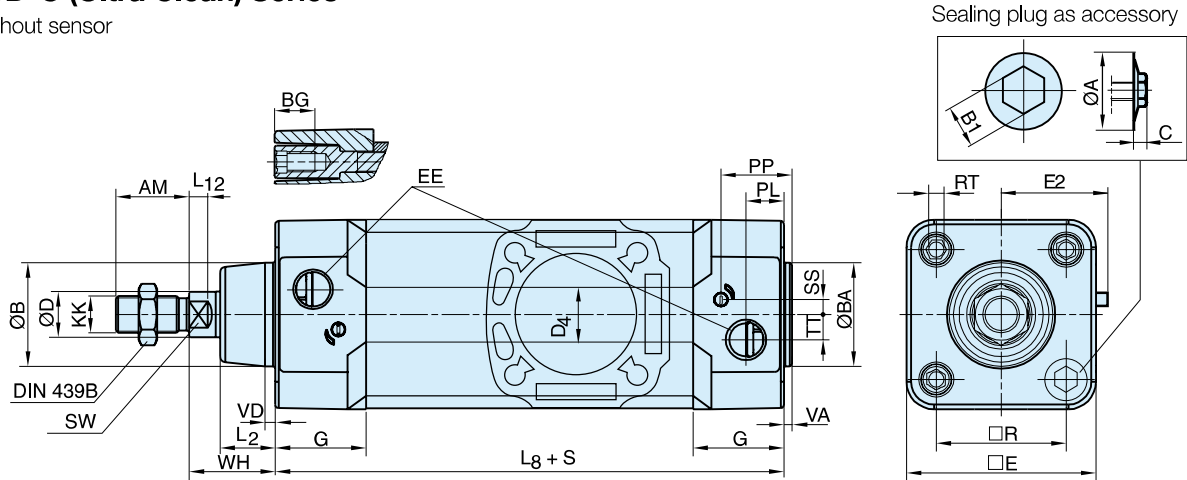

**Internal piston rod thread**

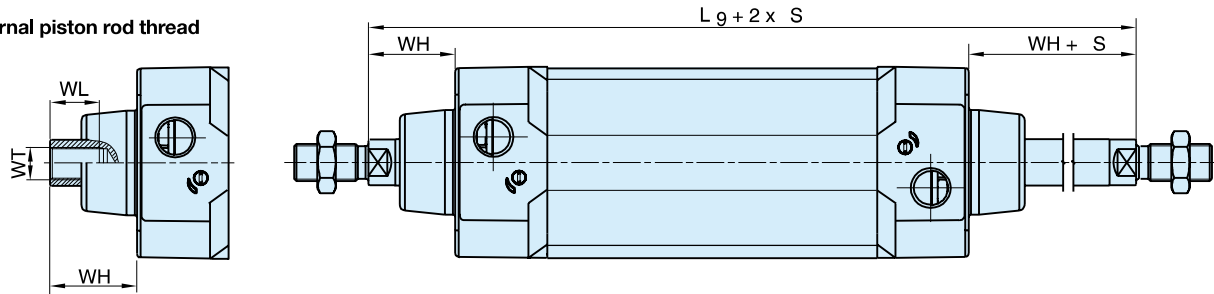

**Dimensions**

Cylinder bore mm	A mm	AM mm	B mm	B1 mm	BA mm	BG mm	C mm	D mm	D4 mm	E mm	EE mm	G mm	KK mm	L2 mm
32	15	22	30	8	30	16	5,2	12	45,0	50,0	G1/8	28,5	M10x1,25	16,0
40	15	24	35	8	35	16	5,2	16	52,0	57,4	G1/4	33,0	M12x1,25	19,0
50	18,5	32	40	10	40	16	6,7	20	60,7	69,4	G1/4	33,5	M16x1,5	24,0
63	18,5	32	45	10	45	16	6,7	20	71,5	82,4	G3/8	39,5	M16x1,5	24,0
80	21,5	40	45	11	45	17	7,8	25	86,7	99,4	G3/8	39,5	M20x1,5	30,0
100	21,5	40	55	11	55	17	7,8	25	106,7	116,0	G1/2	44,5	M20x1,5	32,4
125	24	54	60	13	60	20	9,3	32	134,0	139,0	G1/2	51,0	M27x2	45,0

Cylinder bore mm	L8 mm	L9 mm	L12 mm	PL mm	PP mm	R mm	RT mm	SS mm	SW mm	TT mm	VA mm	VD mm	WH mm	WL mm	WT mm
32	94	146	6,0	13,0	21,8	32,5	M6	4,0	10	4,5	3,5	4,5	26	21	M8x1
40	105	165	6,5	14,0	21,9	38,0	M6	8,0	13	5,5	3,5	4,5	30	23	M10x1,25
50	106	180	8,0	14,0	23,0	46,5	M8	4,0	17	7,5	3,5	5,0	37	31	M14x1,5
63	121	195	8,0	16,4	27,4	56,5	M8	6,5	17	11,0	3,5	5,0	37	31	M14x1,5
80	128	220	10,0	16,0	30,5	72,0	M10	0	22	15,0	3,5	4,0	46	39	M18x1,5
100	138	240	14,0	18,0	35,8	89,0	M10	0	22	20,0	3,5	4,0	51	39	M18x1,5
125	160	290	18,0	28,0	40,5	110,0	M12	0	27	17,5	5,5	6,0	65	53	M24x2

S=Stroke

**Tolerances**

Cylinder bore mm	B	BA	L <sub>8</sub> mm	L <sub>9</sub> mm	R mm	Stroke tolerance up to stroke 500 mm	Stroke tolerance for stroke over 500 mm
32	d11	d11	±0,4	±2	±0,5	+0,3/+2,0	+0,3/+3,0
40	d11	d11	±0,7	±2	±0,5	+0,3/+2,0	+0,3/+3,0
50	d11	d11	±0,7	±2	±0,6	+0,3/+2,0	+0,3/+3,0
63	d11	d11	±0,8	±2	±0,7	+0,3/+2,0	+0,3/+3,0
80	d11	d11	±0,8	±3	±0,7	+0,3/+2,0	+0,3/+3,0
100	d11	d11	±1,0	±3	±0,7	+0,3/+2,0	+0,3/+3,0
125	d11	d11	±1,0	±3	±1,1	+0,3/+2,0	+0,3/+3,0

Cylinder mountings

Intermediate trunnion MT4 for P1D-C Ultra Clean



Not for the P1D-C Pro Clean version.  
 P1D-C Ultra Clean in bore sizes 32 to 80 mm and strokes up to 700 mm. Longer stroke length on request. Shaft square to 90° with air ports only.  
 Material: stainless steel

**Trunnion centred**

The centred trunnion for the P1D-C is ordered with letter D in position 17 (no dimension specified in positions 18-20, letters are NNN).

**Trunnion with optional postion XV measure**

The intermediate trunnion for the P1D-C is ordered with a letter in position 17 and desired XV-measure (3 digit measure in mm in positions 18-20).

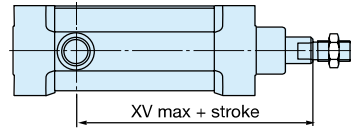
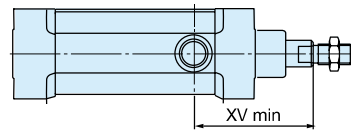
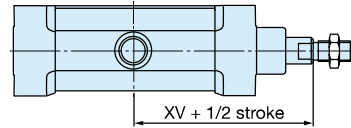
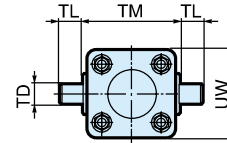

Cyl. bore mm	L1	TL	TM	Ø TD	UW	XV min	XV	XV max
	<b>P1D-C mm</b>	<b>h14 mm</b>	<b>h14 mm</b>	<b>e9 mm</b>	<b>P1D-C mm</b>	<b>P1D-C mm</b>	<b>P1D-C mm</b>	<b>P1D-C mm</b>
32	12	12	50	12	0	69,5	73,0	76,0
40	16	16	63	16	0	78,0	82,5	86,5
50	16	16	75	16	0	85,5	90,0	94,5
63	20	20	90	20	0	103,5	97,5	91,0
80	20	20	110	20	0	112,5	110,0	107,0

**Important:** If the cylinder is ordered with a piston rod protusion (WH dimension), please add this extra length to XVmin, XV and XVmax.